

Revison notes

- A - 29/10/19 - furnishing layouts b/c
- B - 29/10/19 - mezzanine 'storage' units greyed.
- C - 31/10/19 - Key revised & updated reception chairs & grand hall chairs revised.
- D - 5/11/19 - All CH-04,5,6 & 7 chairs replaced with CH-08. - Theatre style layout option shown in grand hall
- E - 5/11/19 - Tb-09 added, reception chair removed
- F - Grand hall entrance doors revised to suit Arch. issue 05 draings. Hall seating numbers increased in ops 2 & 3
- G - 11/11/19 - Key updated
- H - 11/11/19 - CT-10 revised
- I - 19/11/19 - lecturn replaced with a reuse item, key updated.
- M - 20/12/19 hall layout options removed. reception seating revised. Key updated. (in red)
- N - 16/1/20 - key revised / colour coded, Setting out dims added

gunter design associates ltd
 registered number @amalqam
 Uncommon building, 1 Long Lane, London, SE1 4PG
 mobile [redacted] e mail [redacted]

CLIENT	The Furniture Practice
PROJECT	Chicago Booth, London
DRAWING	Gr & Mez, Furnishings plan
SCALE	1/200 @ A3 & 1/100 @ A1
DATE	25/10/19
DWG No.	Chic-001
Revision	N
DRAWING STATUS	For discussion only
DO NOT SCALE FROM DRAWING. USE FIGURED DIMENSIONS ONLY.	

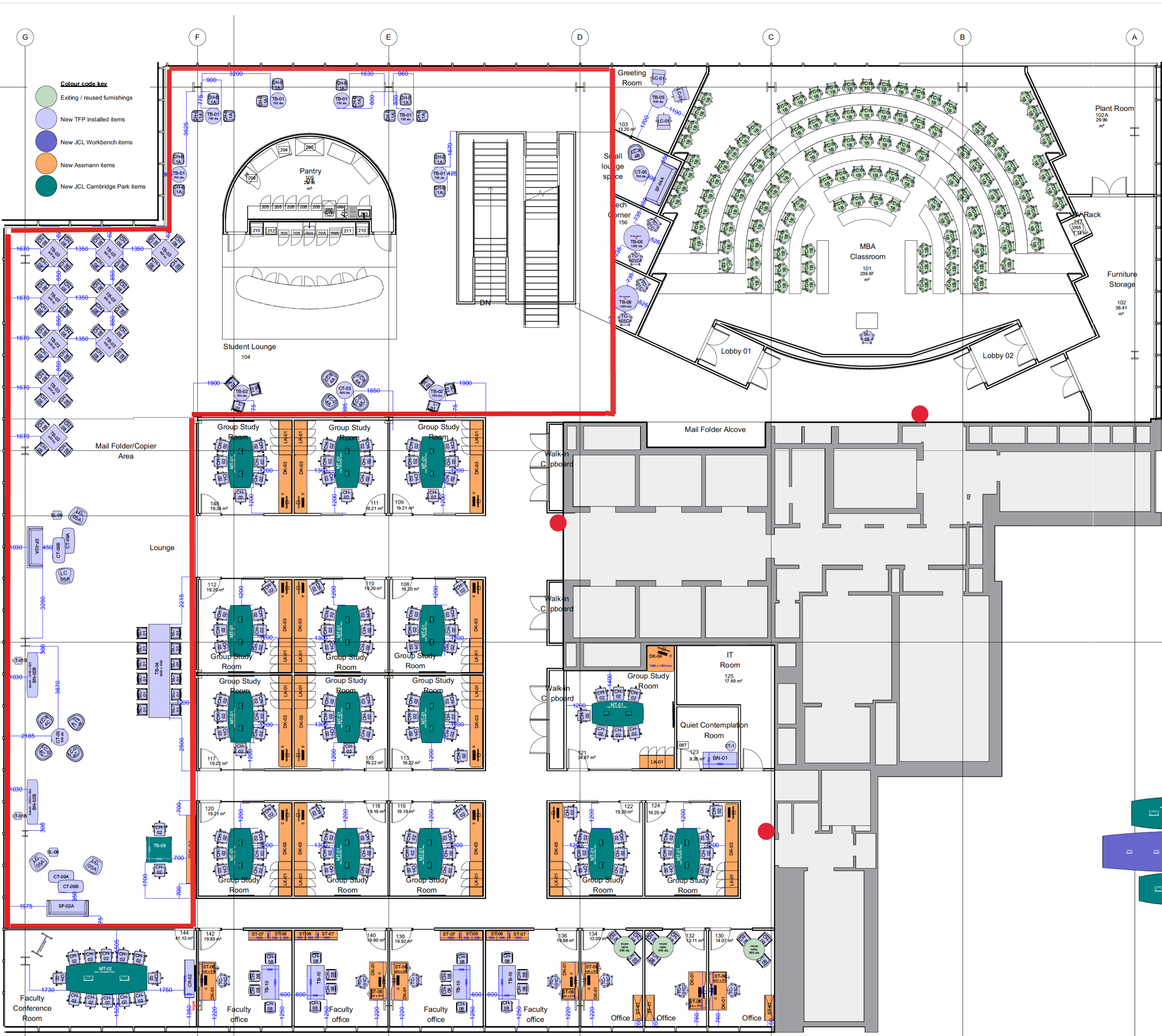

1st Floor

- FURNITURE KEY**
- TC-01A - Herman Miller - Sayi - Task chair. Fully adjustable arms & seat. 5 star base. Fabric: Nieme Havena - (carpet casters)
 - TC-01B REUSE - Herman Miller - Sayi - Task chair. Fully adjustable arms & seat. 5 star base. Fabric: Nieme Havena - (carpet casters)
 - TC-01C - Herman Miller - Sayi - Task chair. Fully adjustable arms & seat. 5 star base. Fabric: Nieme Havena - (carpet casters)
 - TC-01D - Herman Miller - Sayi - Task chair. Seat recumbent. Fabric: Nieme Havena - (carpet casters)
 - CH-01A - Muuto, Fibre - Cable chair. Fabric: Canvas 124. White shell, solid base
 - CH-02 - Boss design, Kera - meeting chair, polished base, black mesh and frame
 - CH-03 - Bunnor, Fine soft 6722A - meeting chair. Devita leather 6628B, (dark brown) polished Al. base
 - CH-04 - Fomassing Link Shell chairs. 52x55x80 Upholstery Remix 2 183 chrome base
 - SL-01 - Andreu World, Flex bar stool/Thermo-polymer seat. 500 x 500 x 490h Valencia Graphite 107-4003
 - SL-02 - Sofline Havana ottoman. Fabric: Tempo 99A-SE Black legs
 - SL-03 - Herman Miller, Sayi stool. Fully adjustable arms & seat. Fabric: Nieme Havena - (carpet casters)
 - LC-01 - Knoll studio - Pilot - low back lounge chair. Leather: Sellaquo Cognac, 4 star base.
 - LC-02 - Fritz Hansen - Pio - Lounge chair. Fabric: Remix 2, 962. Al. legs
 - LC-03A - Norr 11 - Elephant - Lounge chair. Vintage Leather: Futurista, 21003, natural frame & base
 - LC-03B - Norr 11 - Elephant - Lounge chair. Fabric: wool Fawn 124, black oak frame & base
 - LC-04A - Hay - About lounge 81 chair, with seat pads. Fabric: Steelcut Top 3, 883. Swivel base
 - LC-04B - Hay - About lounge 81 chair, with seat pads. Fabric: Steelcut Top 3, 883. Swivel base
 - LC-05A - Sofline A.S. - Noomi String lounge chair. Fabric: Remix 2, 962. Black legs
 - LC-05B - Sofline A.S. - Noomi string chair, with seat pads. Fabric: synergy family LD558, black base
 - LC-05C - Sofline A.S. - Noomi string chair, with seat pads. Fabric: synergy family LD558, black base
 - LC-06 - Sofline Havana, high back lounge chair. Fabric: Tempo 99A-SE Black legs
 - LC-07 - Mood Shift Lounge chair, blue/grey
 - SF-01A - Arper - Saari - 3 seat sofa. Fabric: Umanit 973 - black oak legs
 - SF-01B - Arper - Saari - 3 seat sofa. Fabric: Field 182 - black oak legs
 - SF-02A - Andreu World - Raglan - 3 seat sofa. Fabric: Valencia 107-0020 Mocca - black legs
 - SF-02B - Andreu World - Raglan - 3 seat sofa. Fabric: Valencia 107-0020 Mocca - black legs
 - SF-04A - Andreu World - Couve - 3 seat sofa. Fabric: Valencia 107-0020 Mocca - black legs
 - BN-01 - Andreu World - Raglan - upholstered bench. Fabric: Reviva 834 - black legs
 - BN-02A - Coo design - Four legs bench seat. 1400x550x450. Valencia Mocca 107-0020
 - BN-02B - Coo design - Four legs bench seat. 1100x550x450. Valencia Mocca 107-0020
 - CT-01 - Fritz Hansen - John Coffee table. 800 dia. 370 h - black lacquered oak
 - CT-02 - Shua - Solapa Coffee table. 1200 x 400, 360 h - Walnut veneer
 - CT-03 - Workspaces - Air Coffee table 900da, 360h. Swiss elm warm laminate top, black base
 - CT-04 - Altemuir - FortySeven coffe table. 750 dia x 740 h - grey laminate top, black pad base
 - CT-05 - Altemuir - FortySeven coffe table. 900 sq x 740 h - grey laminate top, black sq base
 - CT-06 - Shua - Solapa Coffee table. 1000 x 600, 360 h - Walnut veneer
 - CT-07 - Workspaces - Air digital Coffee table. 1200 x 800, 385 h - swiss elm warm mfc
 - CT-08 - Shua - Solapa Coffee table. 1200 x 600, 360 h - Walnut veneer
 - CT-09A - Shua - Solapa Coffee table. 1200 x 600, 360 h - Walnut veneer
 - CT-09B - Shua - Solapa Coffee table. 1200 x 600, 360 h - Walnut veneer
 - CT-10A - Andreu World Reverse digital Coffee table. 1200x350h - Oak 378 top, black base
 - CT-10B - Andreu World Reverse digital Coffee table. 1200x350h - Oak 378 top, black base
 - CT-11 - Andreu World Reverse Coffee table. 620x400 - Oak 378 top, black base
 - LT-01A - Altemuir, Host - laptop table. 547 sq x 740 h - melow yellow
 - LT-01B - Altemuir, Host - laptop table. 547 sq x 740 h - melow yellow
 - TB-01 - Altemuir - FortySeven cafe table. 750 dia x 740 h - grey laminate top, black pad base
 - TB-02 - Altemuir - FortySeven cafe table. 900 sq x 740 h - grey laminate top, black sq base
 - TB-03 - Workspaces Hub, high table. 4400 x 500 x 740 h - Fenix, Casca Orinoco 0749 black legs & frame
 - TB-04 - Andreu World - Reverse Table. 800x400 - Oak 378 top, black base
 - TB-05 - Andreu World - Reverse Table. 1200 dia x 740 h - White laminate top & black base
 - TB-06 - Cambridge park Nimbus table. 1200sq x725h Swiss elm warm laminate & black base
 - TB-07 - (New grand hall tables) 1600 dia x 740 h - White MFC & chrome base
 - TB-08 - Workspaces Air table. 1600x800 x740 h - swiss elm warm & black base
 - TB-09 - Cambridge park Nimbus table. 1600x800 x740 h - oak top & ABS base polished
 - TB-10 - Cambridge park Nimbus table. 1600x800 x740 h - oak top & ABS base polished
 - REUSE table, 900 dia x 725 h white MFC, chrome base
 - REUSE table, 900 dia x 725 h white MFC, chrome base
 - REUSE table, 700 dia x 725 h white MFC, chrome base
 - REUSE table, 700 dia x 725 h white MFC, chrome base
 - MT-01 - Cambridge Park - Nimbus 'barne' meeting Table. 2400 x 800 x 1200 x 725 h - Fresh Kronospan Swiss Elm Warm, Polished aluminum base
 - MT-02 - Cambridge Park - Nimbus 'barne' meeting Table. 3800 x 1000 x 1500 x 725 h - Casca Orinoco 0749 fenix top, black base
 - MT-03 - JCL workbench - Beppola 'barne' meeting Table. 3450 x 1000 x 1500 x 725 h - Black American walnut top & base, Fenix Casca Orinoco inlay
 - MT-04 - Cambridge Park - Nimbus 'barne' meeting Table. 3450 x 1000 x 1500 x 725 h - Casca Orinoco 0749 fenix top, black base
 - MT-05 - Cambridge Park - Nimbus meeting Table. 1400 dia x 725 h - Casca Orinoco fenix top, black base
 - DK-01 - Assaman - Buronbel, range, Carvato, Height adj, desk. 1800 x 800 x 850 x 1250h. Top: Acacia MFC, sq corners Large scallop to back of desktop. Control panel with memory and display Edge detail. Sq. Acacia MFC edge. Top Thickness: 25mm, Sq. Frame finish: SN-Signal White, no Modesty Panel
 - DK-02A - Assaman - Buronbel, range, Carvato, Height adj, desk. 1800 x 800 x 850 x 1250h. Top: Acacia MFC, sq corners Large scallop to back of desktop. Control panel with memory and display Edge detail. Sq. Acacia MFC edge. Top Thickness: 25mm, Sq. Frame finish: SN-Signal White, no Modesty Panel
 - DK-02B - Assaman - Buronbel, range, Carvato, Height adj, desk. 1800 x 800 x 850 x 1250h. Top: Acacia MFC, sq corners Large scallop to back of desktop. Control panel with memory and display Edge detail. Sq. Acacia MFC edge. Top Thickness: 25mm, Sq. Frame finish: SN-Signal White, no Modesty Panel
 - DK-03 - Assaman - Buronbel Alvia Desktop 2745 x 600 - baseat, black legs
 - DK-04 - Assaman - Buronbel Alvia Desktop. 1920 x 600 - baseat, black legs
 - DK-05 - Assaman - Buronbel, range, Carvato, Height adj, desk. 1800 x 800 x 850 x 1250h. Top: Acacia MFC, sq corners Large scallop to back of desktop. Control panel with memory and display Edge detail. Sq. Acacia MFC edge. Top Thickness: 25mm, Sq. Frame finish: SN-Signal White, no Modesty Panel
 - ST-01 - Assaman - Alvia, 2 drawer filing unit with top panel. Dims: 1200w x 440d x 810h mm Surround & Drawer. Finish: SN-Signal White MFC, 25mm Top Panel Finish: SN-Signal White
 - ST-02 - Assaman - Alvia, 3 high hinged door shelving unit with top panel & back panel (between 2 units - 1600w x 1185h) Dims: 800w x 485d x 185h mm (4) Overall. 200w x 440d x 1185h mm. Drawers: SN-Signal White MFC, Surround (Carvato), AK-Acacia MFC, 25mm Top Panel Finish: SN-Signal White
 - ST-03 - Assaman - Alvia, 2 high Filing Drawer Unit with top panel (2x between 2 units - 2400w x 440d). 1x top panel for unit - 1200w x 440d. 1200w x 440d x 810h mm Drawers & Surround (carvato). Finish: SN-Signal White MFC, Top Panel Finish: AK-Acacia MFC, Top Panel Thickness: 25mm
 - ST-04 - Assaman Buronbel QM8H & C.C. KD. Steel Pedestal. Dims: 420w x 570d x 800h mm Finish: SN-Signal White steel internal fittings: 2x box drawers (1x with pen tray), 1x filing drawer

- Revisions notes**
- A - 29/10/19 small meeting rooms 145 & 146 & partition reinstated nr. 114
 - B - 29/10/19 small meeting rooms 145 & 146 & partition removed
 - C - 31/10/19 - Key revised & updated, barrel shapped meeting tables revised, faculty offices replanned to avoid embedded column locations (TBC) task chairs recoded. DK-04 enlarged
 - D - 4/11/19 - Faculty office options added, Tb-03 changed, break out settings updated
 - E - 5/11/19 - All CH-04,5,6 & 7 chairs replaced with CH-08
 - F - 5/11/19 - faculty office layout options removed. lounge settings revised
 - G - 7/11/19 - board room, faculty offices revised, benches & laptop tables added to lounge. Contemplation room acoustic panels moved from ceiling to wall. Chairs added to group study rooms.
 - H - 11/11/19 - key updated
 - I - 11/11/19 - CT-10 updated
 - J - 19/11/19 - Stetings revised & key updated.
 - K - 20/12/19 - key updated, (in red) plan revised to suite. L - 10/1/20 - room 121 table rotated
 - M - 16/1/20 - key updated / colour coded, setting out dims addde

<https://www.gunter-jones.co.uk>
 gunter design associates ltd @al amalgam
 Uncommon building, 1 Long Lane, London, SE1 4PG
 mobile [redacted] e mail [redacted]

CLIENT: The Furniture Practice

PROJECT: Chicago Booth, London

DRAWING: 1st Fl. Furnishings plan

SCALE: 1/200 @ A3 & 1/100 @ A1

DATE: 25/10/19

DWG No. Chic-002 Revision M

DRAWING STATUS: For discussion only

DO NOT SCALE FROM DRAWING. USE FIGURED DIMENSIONS ONLY.

- Colour code key**
- Existing / reused furnishings
 - New TFP installed items
 - New JCL Workbench items
 - New Assmann items
 - New JCL Cambridge Park items

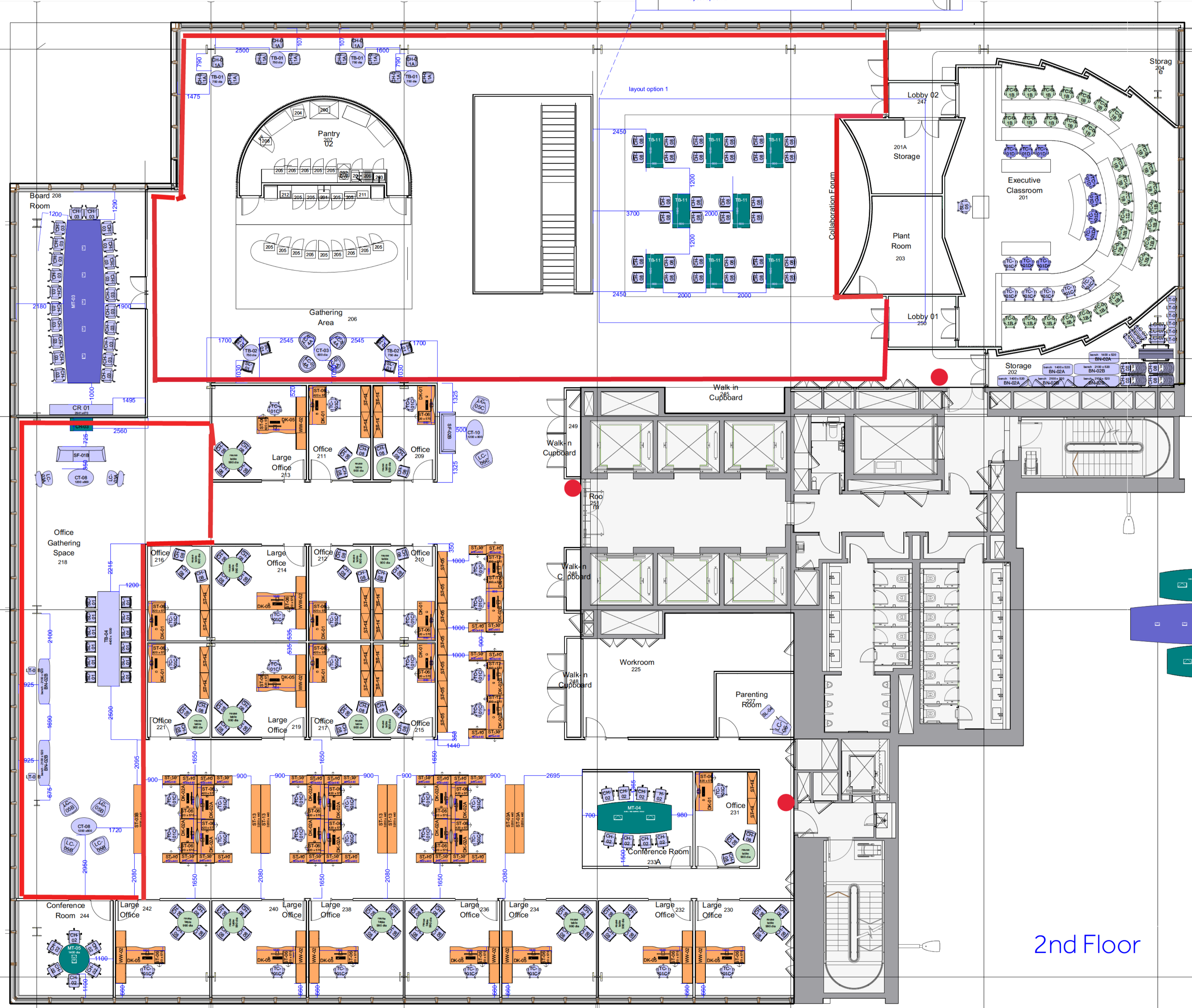
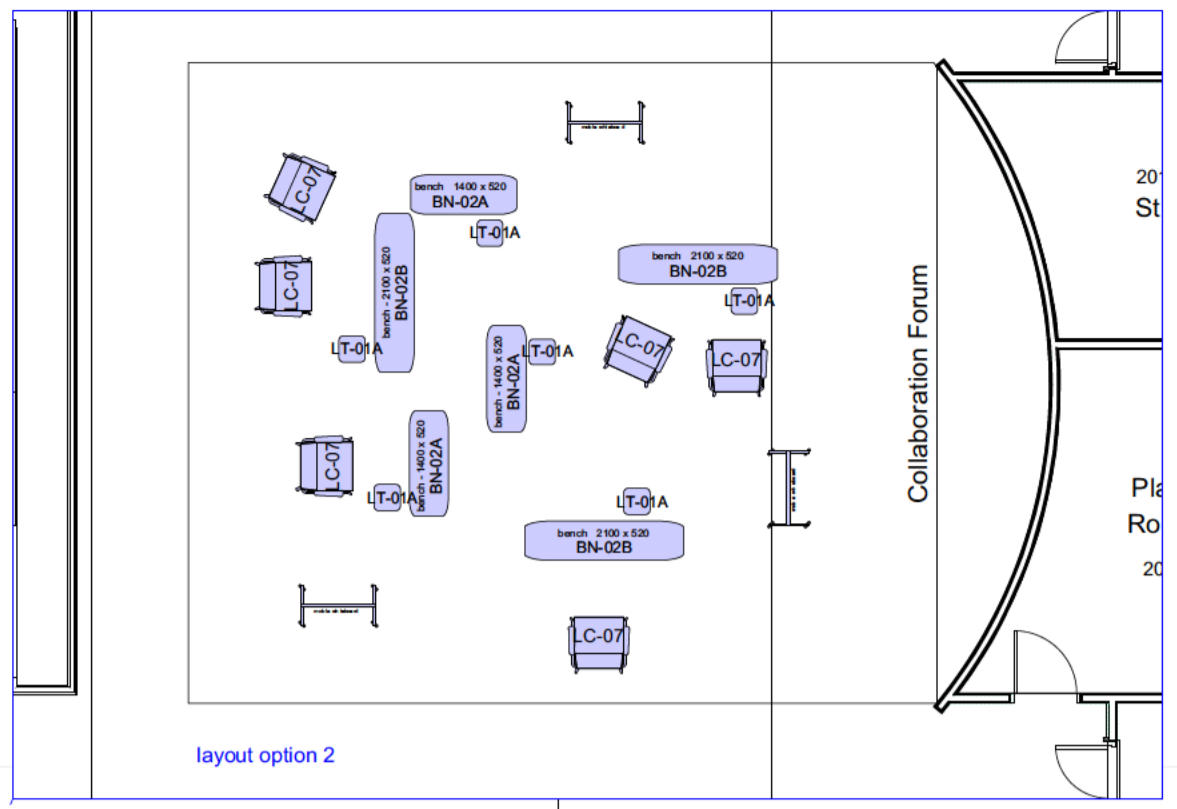

- FURNITURE KEY**
- TC-01A - Herman Miller - Sayl - Task chair
 - TC-01B - Herman Miller - Sayl - Task chair
 - TC-01C - Herman Miller - Sayl - Task chair
 - TC-01D - Herman Miller - Sayl - Task chair
 - CH-01 - Herman Miller - Sayl - Task chair
 - CH-02 - Herman Miller - Sayl - Task chair
 - CH-03 - Herman Miller - Sayl - Task chair
 - CH-04 - Herman Miller - Sayl - Task chair
 - CH-05 - Herman Miller - Sayl - Task chair
 - CH-06 - Herman Miller - Sayl - Task chair
 - CH-07 - Herman Miller - Sayl - Task chair
 - CH-08 - Herman Miller - Sayl - Task chair
 - CH-09 - Herman Miller - Sayl - Task chair
 - CH-10 - Herman Miller - Sayl - Task chair
 - CH-11 - Herman Miller - Sayl - Task chair
 - CH-12 - Herman Miller - Sayl - Task chair
 - CH-13 - Herman Miller - Sayl - Task chair
 - CH-14 - Herman Miller - Sayl - Task chair
 - CH-15 - Herman Miller - Sayl - Task chair
 - CH-16 - Herman Miller - Sayl - Task chair
 - CH-17 - Herman Miller - Sayl - Task chair
 - CH-18 - Herman Miller - Sayl - Task chair
 - CH-19 - Herman Miller - Sayl - Task chair
 - CH-20 - Herman Miller - Sayl - Task chair
 - CH-21 - Herman Miller - Sayl - Task chair
 - CH-22 - Herman Miller - Sayl - Task chair
 - CH-23 - Herman Miller - Sayl - Task chair
 - CH-24 - Herman Miller - Sayl - Task chair
 - CH-25 - Herman Miller - Sayl - Task chair
 - CH-26 - Herman Miller - Sayl - Task chair
 - CH-27 - Herman Miller - Sayl - Task chair
 - CH-28 - Herman Miller - Sayl - Task chair
 - CH-29 - Herman Miller - Sayl - Task chair
 - CH-30 - Herman Miller - Sayl - Task chair
 - CH-31 - Herman Miller - Sayl - Task chair
 - CH-32 - Herman Miller - Sayl - Task chair
 - CH-33 - Herman Miller - Sayl - Task chair
 - CH-34 - Herman Miller - Sayl - Task chair
 - CH-35 - Herman Miller - Sayl - Task chair
 - CH-36 - Herman Miller - Sayl - Task chair
 - CH-37 - Herman Miller - Sayl - Task chair
 - CH-38 - Herman Miller - Sayl - Task chair
 - CH-39 - Herman Miller - Sayl - Task chair
 - CH-40 - Herman Miller - Sayl - Task chair
 - CH-41 - Herman Miller - Sayl - Task chair
 - CH-42 - Herman Miller - Sayl - Task chair
 - CH-43 - Herman Miller - Sayl - Task chair
 - CH-44 - Herman Miller - Sayl - Task chair
 - CH-45 - Herman Miller - Sayl - Task chair
 - CH-46 - Herman Miller - Sayl - Task chair
 - CH-47 - Herman Miller - Sayl - Task chair
 - CH-48 - Herman Miller - Sayl - Task chair
 - CH-49 - Herman Miller - Sayl - Task chair
 - CH-50 - Herman Miller - Sayl - Task chair
 - CH-51 - Herman Miller - Sayl - Task chair
 - CH-52 - Herman Miller - Sayl - Task chair
 - CH-53 - Herman Miller - Sayl - Task chair
 - CH-54 - Herman Miller - Sayl - Task chair
 - CH-55 - Herman Miller - Sayl - Task chair
 - CH-56 - Herman Miller - Sayl - Task chair
 - CH-57 - Herman Miller - Sayl - Task chair
 - CH-58 - Herman Miller - Sayl - Task chair
 - CH-59 - Herman Miller - Sayl - Task chair
 - CH-60 - Herman Miller - Sayl - Task chair
 - CH-61 - Herman Miller - Sayl - Task chair
 - CH-62 - Herman Miller - Sayl - Task chair
 - CH-63 - Herman Miller - Sayl - Task chair
 - CH-64 - Herman Miller - Sayl - Task chair
 - CH-65 - Herman Miller - Sayl - Task chair
 - CH-66 - Herman Miller - Sayl - Task chair
 - CH-67 - Herman Miller - Sayl - Task chair
 - CH-68 - Herman Miller - Sayl - Task chair
 - CH-69 - Herman Miller - Sayl - Task chair
 - CH-70 - Herman Miller - Sayl - Task chair
 - CH-71 - Herman Miller - Sayl - Task chair
 - CH-72 - Herman Miller - Sayl - Task chair
 - CH-73 - Herman Miller - Sayl - Task chair
 - CH-74 - Herman Miller - Sayl - Task chair
 - CH-75 - Herman Miller - Sayl - Task chair
 - CH-76 - Herman Miller - Sayl - Task chair
 - CH-77 - Herman Miller - Sayl - Task chair
 - CH-78 - Herman Miller - Sayl - Task chair
 - CH-79 - Herman Miller - Sayl - Task chair
 - CH-80 - Herman Miller - Sayl - Task chair
 - CH-81 - Herman Miller - Sayl - Task chair
 - CH-82 - Herman Miller - Sayl - Task chair
 - CH-83 - Herman Miller - Sayl - Task chair
 - CH-84 - Herman Miller - Sayl - Task chair
 - CH-85 - Herman Miller - Sayl - Task chair
 - CH-86 - Herman Miller - Sayl - Task chair
 - CH-87 - Herman Miller - Sayl - Task chair
 - CH-88 - Herman Miller - Sayl - Task chair
 - CH-89 - Herman Miller - Sayl - Task chair
 - CH-90 - Herman Miller - Sayl - Task chair
 - CH-91 - Herman Miller - Sayl - Task chair
 - CH-92 - Herman Miller - Sayl - Task chair
 - CH-93 - Herman Miller - Sayl - Task chair
 - CH-94 - Herman Miller - Sayl - Task chair
 - CH-95 - Herman Miller - Sayl - Task chair
 - CH-96 - Herman Miller - Sayl - Task chair
 - CH-97 - Herman Miller - Sayl - Task chair
 - CH-98 - Herman Miller - Sayl - Task chair
 - CH-99 - Herman Miller - Sayl - Task chair
 - CH-100 - Herman Miller - Sayl - Task chair

- ST-01 - Assman - Alvia 2 drawer filing unit with top panel
- ST-02 - Assman - Alvia 2 drawer filing unit with top panel
- ST-03 - Assman - Alvia 2 drawer filing unit with top panel
- ST-04 - Assman - Alvia 2 drawer filing unit with top panel
- ST-05 - Assman - Alvia 2 drawer filing unit with top panel
- ST-06 - Assman - Alvia 2 drawer filing unit with top panel
- ST-07 - Assman - Alvia 2 drawer filing unit with top panel
- ST-08 - Assman - Alvia 2 drawer filing unit with top panel
- ST-09 - Assman - Alvia 2 drawer filing unit with top panel
- ST-10 - Assman - Alvia 2 drawer filing unit with top panel
- ST-11 - Assman - Alvia 2 drawer filing unit with top panel
- ST-12 - Assman - Alvia 2 drawer filing unit with top panel
- ST-13 - Assman - Alvia 2 drawer filing unit with top panel
- ST-14 - Assman - Alvia 2 drawer filing unit with top panel
- ST-15 - Assman - Alvia 2 drawer filing unit with top panel
- ST-16 - Assman - Alvia 2 drawer filing unit with top panel
- ST-17 - Assman - Alvia 2 drawer filing unit with top panel
- ST-18 - Assman - Alvia 2 drawer filing unit with top panel
- ST-19 - Assman - Alvia 2 drawer filing unit with top panel
- ST-20 - Assman - Alvia 2 drawer filing unit with top panel
- ST-21 - Assman - Alvia 2 drawer filing unit with top panel
- ST-22 - Assman - Alvia 2 drawer filing unit with top panel
- ST-23 - Assman - Alvia 2 drawer filing unit with top panel
- ST-24 - Assman - Alvia 2 drawer filing unit with top panel
- ST-25 - Assman - Alvia 2 drawer filing unit with top panel
- ST-26 - Assman - Alvia 2 drawer filing unit with top panel
- ST-27 - Assman - Alvia 2 drawer filing unit with top panel
- ST-28 - Assman - Alvia 2 drawer filing unit with top panel
- ST-29 - Assman - Alvia 2 drawer filing unit with top panel
- ST-30 - Assman - Alvia 2 drawer filing unit with top panel
- ST-31 - Assman - Alvia 2 drawer filing unit with top panel
- ST-32 - Assman - Alvia 2 drawer filing unit with top panel
- ST-33 - Assman - Alvia 2 drawer filing unit with top panel
- ST-34 - Assman - Alvia 2 drawer filing unit with top panel
- ST-35 - Assman - Alvia 2 drawer filing unit with top panel
- ST-36 - Assman - Alvia 2 drawer filing unit with top panel
- ST-37 - Assman - Alvia 2 drawer filing unit with top panel
- ST-38 - Assman - Alvia 2 drawer filing unit with top panel
- ST-39 - Assman - Alvia 2 drawer filing unit with top panel
- ST-40 - Assman - Alvia 2 drawer filing unit with top panel
- ST-41 - Assman - Alvia 2 drawer filing unit with top panel
- ST-42 - Assman - Alvia 2 drawer filing unit with top panel
- ST-43 - Assman - Alvia 2 drawer filing unit with top panel
- ST-44 - Assman - Alvia 2 drawer filing unit with top panel
- ST-45 - Assman - Alvia 2 drawer filing unit with top panel
- ST-46 - Assman - Alvia 2 drawer filing unit with top panel
- ST-47 - Assman - Alvia 2 drawer filing unit with top panel
- ST-48 - Assman - Alvia 2 drawer filing unit with top panel
- ST-49 - Assman - Alvia 2 drawer filing unit with top panel
- ST-50 - Assman - Alvia 2 drawer filing unit with top panel
- ST-51 - Assman - Alvia 2 drawer filing unit with top panel
- ST-52 - Assman - Alvia 2 drawer filing unit with top panel
- ST-53 - Assman - Alvia 2 drawer filing unit with top panel
- ST-54 - Assman - Alvia 2 drawer filing unit with top panel
- ST-55 - Assman - Alvia 2 drawer filing unit with top panel
- ST-56 - Assman - Alvia 2 drawer filing unit with top panel
- ST-57 - Assman - Alvia 2 drawer filing unit with top panel
- ST-58 - Assman - Alvia 2 drawer filing unit with top panel
- ST-59 - Assman - Alvia 2 drawer filing unit with top panel
- ST-60 - Assman - Alvia 2 drawer filing unit with top panel
- ST-61 - Assman - Alvia 2 drawer filing unit with top panel
- ST-62 - Assman - Alvia 2 drawer filing unit with top panel
- ST-63 - Assman - Alvia 2 drawer filing unit with top panel
- ST-64 - Assman - Alvia 2 drawer filing unit with top panel
- ST-65 - Assman - Alvia 2 drawer filing unit with top panel
- ST-66 - Assman - Alvia 2 drawer filing unit with top panel
- ST-67 - Assman - Alvia 2 drawer filing unit with top panel
- ST-68 - Assman - Alvia 2 drawer filing unit with top panel
- ST-69 - Assman - Alvia 2 drawer filing unit with top panel
- ST-70 - Assman - Alvia 2 drawer filing unit with top panel
- ST-71 - Assman - Alvia 2 drawer filing unit with top panel
- ST-72 - Assman - Alvia 2 drawer filing unit with top panel
- ST-73 - Assman - Alvia 2 drawer filing unit with top panel
- ST-74 - Assman - Alvia 2 drawer filing unit with top panel
- ST-75 - Assman - Alvia 2 drawer filing unit with top panel
- ST-76 - Assman - Alvia 2 drawer filing unit with top panel
- ST-77 - Assman - Alvia 2 drawer filing unit with top panel
- ST-78 - Assman - Alvia 2 drawer filing unit with top panel
- ST-79 - Assman - Alvia 2 drawer filing unit with top panel
- ST-80 - Assman - Alvia 2 drawer filing unit with top panel
- ST-81 - Assman - Alvia 2 drawer filing unit with top panel
- ST-82 - Assman - Alvia 2 drawer filing unit with top panel
- ST-83 - Assman - Alvia 2 drawer filing unit with top panel
- ST-84 - Assman - Alvia 2 drawer filing unit with top panel
- ST-85 - Assman - Alvia 2 drawer filing unit with top panel
- ST-86 - Assman - Alvia 2 drawer filing unit with top panel
- ST-87 - Assman - Alvia 2 drawer filing unit with top panel
- ST-88 - Assman - Alvia 2 drawer filing unit with top panel
- ST-89 - Assman - Alvia 2 drawer filing unit with top panel
- ST-90 - Assman - Alvia 2 drawer filing unit with top panel
- ST-91 - Assman - Alvia 2 drawer filing unit with top panel
- ST-92 - Assman - Alvia 2 drawer filing unit with top panel
- ST-93 - Assman - Alvia 2 drawer filing unit with top panel
- ST-94 - Assman - Alvia 2 drawer filing unit with top panel
- ST-95 - Assman - Alvia 2 drawer filing unit with top panel
- ST-96 - Assman - Alvia 2 drawer filing unit with top panel
- ST-97 - Assman - Alvia 2 drawer filing unit with top panel
- ST-98 - Assman - Alvia 2 drawer filing unit with top panel
- ST-99 - Assman - Alvia 2 drawer filing unit with top panel
- ST-100 - Assman - Alvia 2 drawer filing unit with top panel

- Revisions notes**
- A - 29/10/19 large mtg room tables changed, sofa
 - SF-01B added - Open plan type 2 workstations TBC
 - B - 29/10/19 type 2 workstations revised
 - C - 31/10/19 - Key revised & updated, barrel shaped meeting tables revised, open plan workstation codes changed task chairs recoded, sofas revised.
 - D - 4/11/19 - Board room reduced in size, table option shown, Collaboration forum options shown, open plan office areas revised.
 - E - 5/11/19 - All CH-04,5,6 & 7 chairs replaced with CH-08
 - F - 5/11/19 - open plan office areas & collaboration forum revised
 - G - 7/11/19 - layout options for 244, Collaboration forum revised benches added to lounge
 - H - 11/11/19 - Key updated
 - I - 11/11/19 - CT-10 revised
 - J - 19/11/19 - Stetings revised & key updated.
 - K - 20/12/19 - key updated, (in red) plan revised to suite
 - L - 16/1/20 - key updated / colour coded, setting out dims added

<https://www.gunter-jones.co.uk>
gunter design associates ltd
registered number 3858765
@amalagam
Uncommon building, 1 Long Lane, London, SE1 4PG
mobile [redacted] e mail [redacted]

CLIENT: The Furniture Practice
PROJECT: Chicago Booth, London
DRAWING: 2nd Fl. Furnishings plan
SCALE: 1/200 @ A3 & 1/100 @ A1
DATE: 28/10/19
DWG No: Chic-003 Revision: L
DRAWING STATUS: For discussion only
DO NOT SCALE FROM DRAWING. USE FIGURED DIMENSIONS ONLY.